

# PTFE Seated Butterfly Valve

## VA-20

### Design Features:

- Top Flange Drilled to fit ISO 5211 dimensions.
- Heavy Duty One Piece wafer Type Body Design.
- Extended Neck Serves for 50mm (2") piping insulation from line media.
- Blow Out Proof Stem Sealing.
- Both Single & Double Piece Stem Design with heavy duty square grooved Disc/Stem Connections.
- Moulded PTFE Ring serves as flange gaskets for Sealing.
- Low Pressure Loss.

### Conformity to Standard & Codes:

#### Design Standard:

API 609, BS5155, ISO5211

#### Face to Face Dimension:

API 609

#### Ends Connections:

Wafer Ends Suitable for insertation between ASME B16.5 #150, BS 4504 PN10/PN16, BS10 Table D-E Flanges

#### Range:

40mm to 300mm

#### Valve Testing:

API 598

### Applications

- HVAC
- Sugar
- Chemical and petro chemical
- Pulp and paper industries
- Food processing
- Water work systems
- Sewage plants
- Pharmaceutical



DOC. NO.: VAV-C-1036; REV. NO.:00; REV. DATE: 04-04-2016



## PART LIST

S. NO.	PART NAME	MATERIAL	SPECIFICATION
1.	BODY	CAST IRON	BS 1452 GR. 220 / IS 210 GR. 220
2.	DISC	STAINLESS STEEL	ASTM A351 GR. CF8/CF8M
3.	SEAT	RUBBER SUPPORTED PTFE	BS 6564
4.	MAIN SHAFT	STAINLESS STEEL	ASTM A 276 GR. 410
5.	PIVOT SHAFT	STAINLESS STEEL	ASTM A 276 GR. 410
6.	DOWEL-PIN	CARBON STEEL	ASTM A105
7.	LOCK PLATE	CARBON STEEL	ASTM A105
8.	FASTNERS	STAINLESS STEEL	SS 201

Note: Contact Factory for other Technical Detail/Other Grade Material.

## DIMENSIONS

SIZE	A	B	C	D	E	F	G	H	I	J
40MM	33	40	73	109	65	50	9.5	27.5	7	4
50MM	43	50	77	132	65	50	9.5	30.0	7	4
65MM	46	65	84	140	65	50	9.5	30.0	7	4
80MM	46	78	96	147	65	50	9.5	30.0	7	4
100MM	52	100	112	172	90	70	11	30.0	9	4
125MM	56	122	121	187	90	70	11	30.0	9	4
150MM	56	148	134	201	90	70	14	30.0	9	4
200MM	60	200	168	229	125	102	17	35.0	11	4
250MM	68	249	202	269	125	102	20	35.0	11	4
300MM	78	300	234	298	125	102	20	38.0	11	4

Note: All dimensions are in mm unless and otherwise specified.

## HAND LEVER

SIZE	L	H1	H2
40/50/65/80MM	240.00	25.00	31.00
100/125/150MM	290.00	25.00	31.00
200MM	340.00	28.00	33.00
250/300MM	550.00	32.00	35.00

## GEAR BOX SIZES

SIZE	RATIO	TURN TO CLOSE 90°	MAX. OUTPUT TORQUE (NM)	A	B	C	D	E
32 TO 150mm (1¼" - 6")	25:1	6.25	125	145	200	60	50 or 70	4
200 TO 300mm (8" - 12")	32:1	8.00	500	240	300	75	102	4

NOTE: VTM designed electrical actuators are available on demand.  
VTM designed pneumatic actuators are available on demand.

## GUARANTEE

All valves are guaranteed against any manufacturing defects for a period of 12 months from date of supply, provided the valves have not been misused, damaged or installed for services they are not recommended. The company shall be liable to furnish part / parts thereof or full valve as the company may deem fit.

# V.A. VALVES

ISO 9001-2008 Certified

Regd. Office & Works: Udyog Nagar, Gadaipur, Jalandhar City -144 004

Phone: +91-181-2601540, 2601541 Fax: +91-181-2601741

E-mail : marketing@vk-utam.com, info@vtm-valves.com

Website : [www.vtm-utam.com](http://www.vtm-utam.com), [www.vtm-valves.com](http://www.vtm-valves.com)

Due to continuous development program, design and data in this leaflet are subject to change without prior notice.

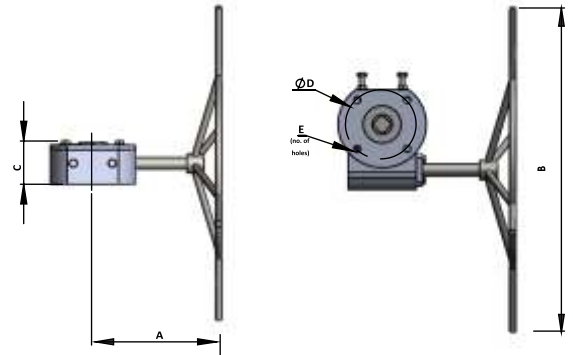
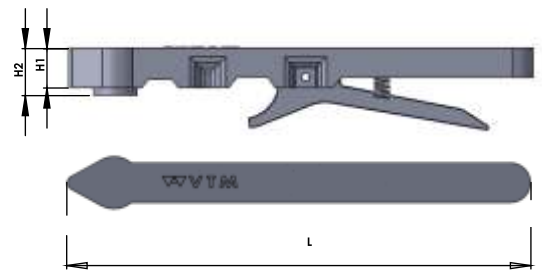
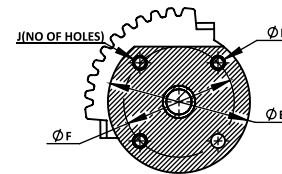
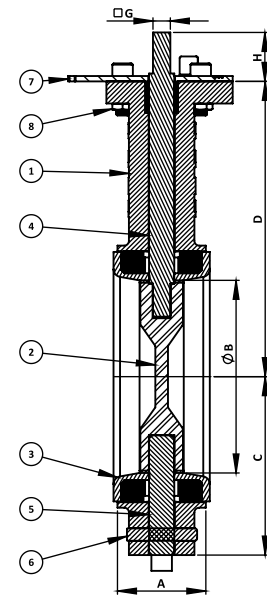

## TEST PRESSURE

RATING	BODY (Kg/cm <sup>2</sup> )	SEAT (Kg/cm <sup>2</sup> )
PN 10	15	11
PN 16	24	17.6

Authorized Stockist

Our associates:



PIONEERING FLUID CONTROLS