

Cast Bronze Balancing Valve

VA-31B

Design Features:

- Only one valve for 5 functions: Presetting, Measuring, Isolating, Filling & Draining.
- Oblique Valve Design enhances Higher Flow Rate & Minimizes Pressure Drop.
- Infinitely adjustable Hand Wheel with concealed Memory feature for Precise & temper proof balancing.
- Numeric Display of the Pre-setting depending upon the position of the Hand Wheel.
- Non Rising Stem with maintenance free stem seal due to double O-Ring.
- Special Seating of PTFE/EPDM to ensure Zero Leakage and Shut off; Safe & Reliable.
- Higher Rangeability of the Flow Rate.
- Near Linear Flow Characteristics allows for better Valve Authority.
- Pressure Test Points available for different flow testing equipments

Conformity to Standard & Codes:

Design Standard:

BS 7350

Face to Face Dimension:

BS 7350

Ends Connections:

Flanged Ends to Suit

BS4504 PN10/16,

ASME B16.5 #150, BS10 Table D/E.

Range:

65mm (2.1/2") to 400mm (16")

Valve Testing:

BS 6755-1

Applications

- Heating & Cooling Systems
- Tap Water Systems
- Water Supply & Distribution Systems
- Hydronic Balancing Systems

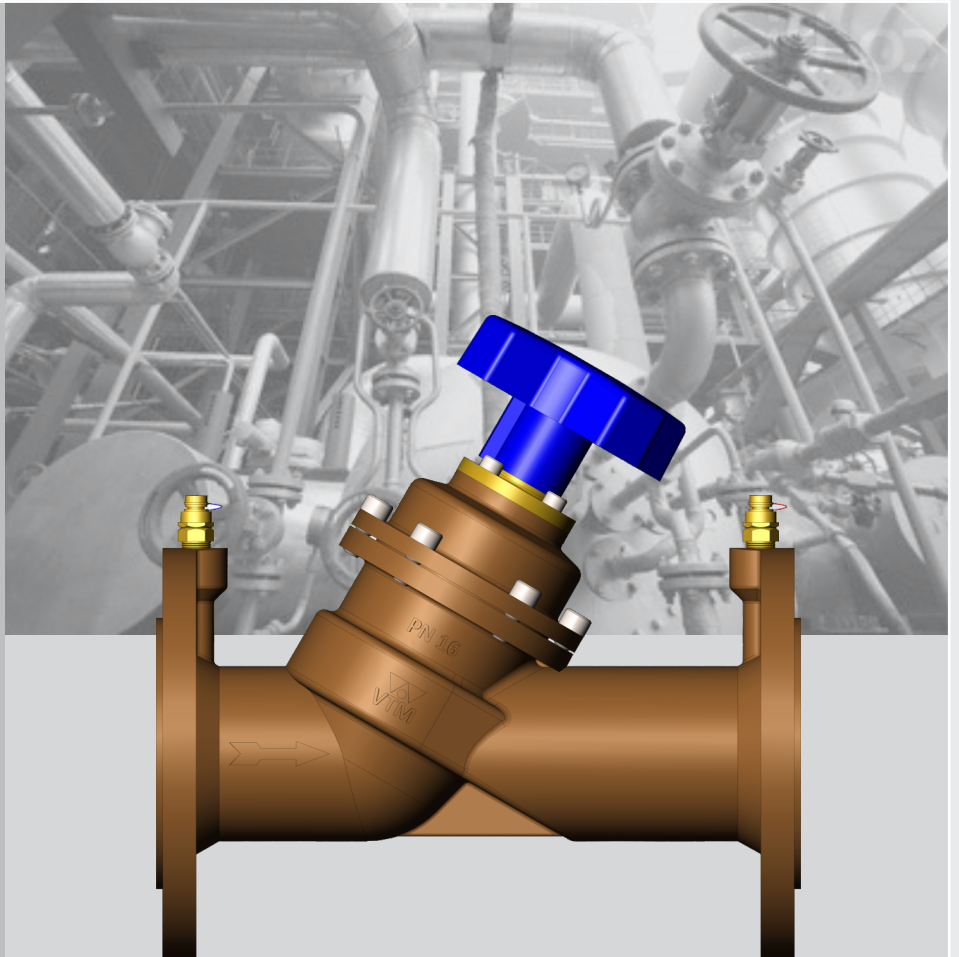

DOC. NO. : VAV-C-1037; REV. NO. : 00; REV. DATE: 04-04-2016



PART LIST

S.NO.	PART NAME	MATERIAL	SPECIFICATION
1.	BODY	CAST BRONZE	BS1400 GR. LG2/ IS 318 GR.LTB2
2.	BONNET	CAST BRONZE	BS1400 GR. LG2/ IS 318 GR.LTB2
3.	BALANCING CONE CUM DISC	CAST BRONZE	BS1400 GR. LG2/ IS 318 GR.LTB2
4.	STEM	BRASS	BS 2874 GR. CZ 114
5.	BONNET COVER	BRASS	BS 2874 GR. CZ 114
6.	MEMORY DEVICE	BRASS	BS 2874 GR. CZ 114
7.	STOP PIN	STAINLESS STEEL	ASTM A276 GR. 304
8.	STEM SCREW	BRASS	BS 2874 GR. CZ 114
9.	BODY/DISC O-RING	RUBBER	EPDM
10.	BODY/BONNET FLAT RING	RUBBER	EPDM
11.	BONNET/STEM O-RING	RUBBER	EPDM
12.	STEM/MEMORY DEVICE O-RING	RUBBER	EPDM
13.	SEAT	RUBBER	EPDM
14.	TEST POINT	BRASS	BS 2874 GR. CZ 114
15.	HAND WHEEL	PLASTIC & ALUMINIUM	NYLON & BS1490

Note: 1. Contact Factory for other Technical Detail/Special Grade Material.

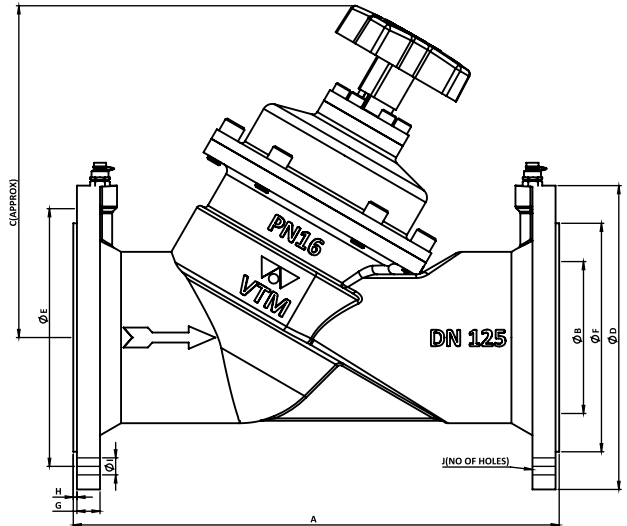

DIMENSIONS

SIZE		FLANGED ENDS									
NPS	DN	A	B	C	D	E	F	G	H	I	J
2.1/2"	65MM	290	65	220	185	145	122	15	3	18	4
3"	80MM	310	80	290	200	160	138	17	3	18	8
4"	100MM	350	100	410	220	180	158	17	3	18	8
5"	125MM	400	125	450	250	210	188	19	3	18	8
6"	150MM	480	150	490	285	240	212	19	3	22	8
8"	200MM	600	200	590	340	295	268	21	3	22	12
10"	250MM	730	250	760	405	355	320	23	3	26	12
12"	300MM	850	300	820	460	410	378	24	4	26	12
14"	350MM	980	350	880	520	470	438	26	4	26	16
16"	400MM	1100	400	940	580	525	490	28	4	30	16

Note: 1. All Dimensions are in mm unless otherwise specified.
2. Flange dimensions are as per BS4504 PN16 in table.
Same are available in other standard on request.

PREFERRED INSTALLATION POSITIONS

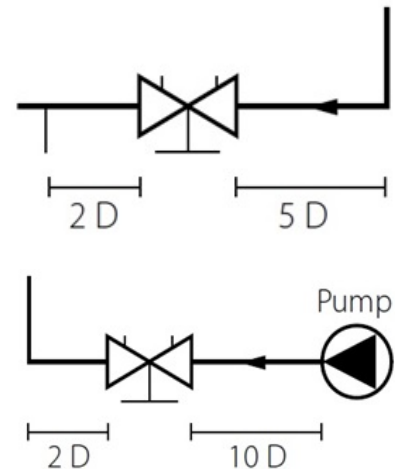

TEST PRESSURE

RATING	HYDROLIC	
	SHELL (Kg/cm ²)	SEAT (Kg/cm ²)
PN 16	24.0	17.6

GUARANTEE

All valves are guaranteed against any manufacturing defects for a period of 12 months from date of supply, provided the valves have not been misused, damaged or installed for services they are not recommended. The company shall be liable to furnish part / parts thereof or full valve as the company may deem fit.

V.A. VALVES

ISO 9001-2008 Certified

Regd. Office & Works: Udyog Nagar, Gadaipur, Jalandhar City -144 004

Phone: +91-181-2601540, 2601541 Fax: +91-181-2601741

E-mail : marketing@vk-utam.com, info@vtm-valves.com

Website : www.vtm-utam.com, www.vtm-valves.com

Due to continuous development program, design and data in this leaflet are subject to change without prior notice.

Authorized Stockist

Our associates:



PIONEERING FLUID CONTROLS